

# 600 Series\*

## Class 1 LED Warning Light — 6" Oval



\*Formerly "Michigan" Series

The 600 Series Class 1 LED Warning Light produces an attention-grabbing warning signal that is designed to meet the demands of multiple commercial vehicles including work trucks, municipal, construction, tow, and delivery. Available in both a 4" round and a 6" oval option, the Michigan series produces a powerful amber or green warning signal. Comes standard with 8 different flash patterns to choose from and is easily connected to your vehicle with the included three pin amp connector. Get noticed and stay safe with the Michigan Series of warning lights.

### FEATURES

- 4" round and 6" oval available in the series
- Amber or green LED options
- High output LED's with 8 flash patterns
- Available with grommet mount and connector
- SAE CLASS 1 Certified



### FLASH PATTERNS

1. Quint
2. Rapid Single
3. Double
4. Quad
5. Single Flash
6. Single Slow
7. Single Pace
8. Rapid Double

### OPTIONS

LENS	LED	MOUNT	CONNECTOR
CLEAR	AMBER	Grommet	Wire w/3 pin amp connector or order without connector
CLEAR	GREEN	Grommet	Wire w/3 pin amp connector

### SPECIFICATIONS

**INPUT VOLTAGE RANGE**  
9-16VDC

**CURRENT DRAW**  
255/411mA (min/max)

**LED COUNT**  
20

**FLASH PATTERNS**  
8

**OPERATING TEMPERATURE**  
-40° C to +65° C

**DIMENSIONS**  
Height – 1.06"  
Length – 7.44"

**MOUNTING**  
Grommet

**CERTIFICATIONS**  
SAE Standard: J595, Class 1  
IP Code IP67

**WARRANTY**  
3 YEAR

600 SERIES CLASS 1 LED WARNING LIGHT – 6" OVAL

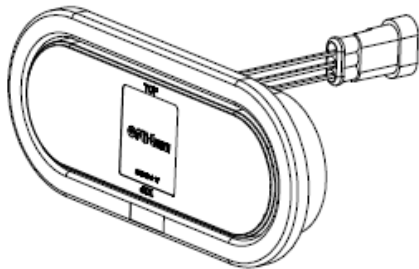
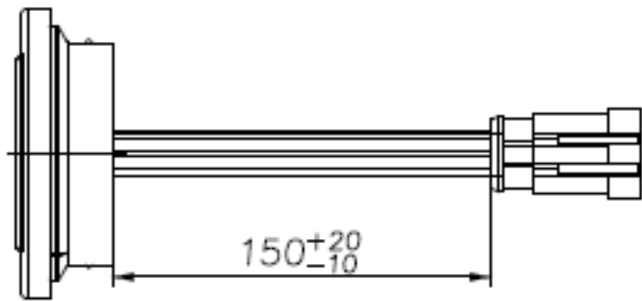
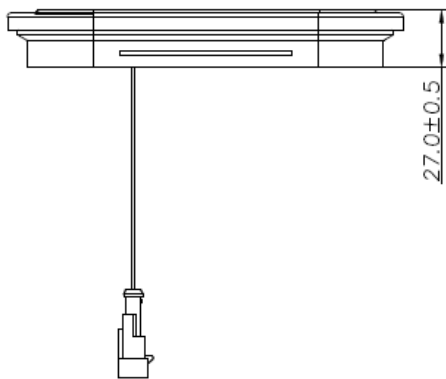
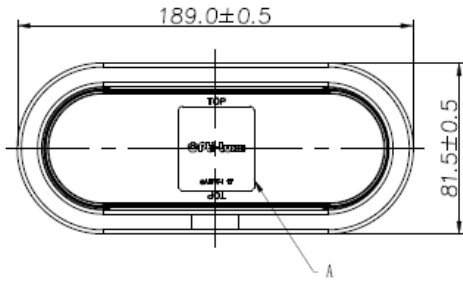

PART NUMBER	MOUNT	LENS / LED	CONNECTOR
100WA0001	GROMMET	○ ● CLEAR / AMBER	Wire w/3 pin amp connector
100WA0005	GROMMET	○ ● CLEAR / GREEN	—
110WA0010	GROMMET	○ ● CLEAR / GREEN	Wire w/3 pin amp connector w/jumper harness kit
110WA0014	GROMMET	○ ● CLEAR / AMBER	—

LEARN MORE

To learn more about the 600 Series LED Beacon, please visit our website at [www.opti-luxx.com](http://www.opti-luxx.com) or call (616) 379-4142. Also, see our lighting products in action by following our YouTube channel.



Follow us on YouTube to see more Opti-Luxx products in action, including available flash patterns!



[www.opti-luxx.com](http://www.opti-luxx.com)  
(616) 379-4142