

PHOENIX

Class 1 LED Light Bar

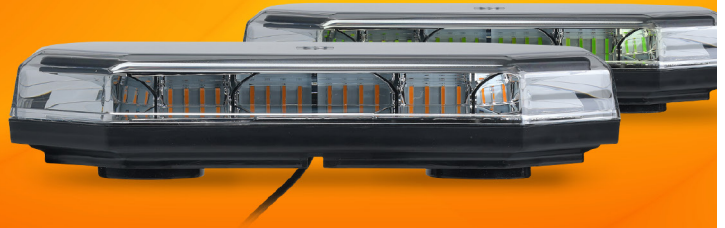

The Phoenix Class 1 LED Light Bar is a sturdy, compact-designed high-profile light bar that produces a powerful amber, white, or green warning signal. Measuring 15" wide, this versatile light bar packs a punch despite its small footprint. Multiple mounting options available, including a magnetic mount which includes a cigarette lighter adapter that allows you to toggle through all 10 flash patterns quickly and easily, providing you with great flexibility on the job. A perfect solution for multiple applications, including construction, municipal, service vehicles, and work trucks. Multiple options available for both LED and lens color, including a green LED signal.

FEATURES

- 6 light bars in the series
- Rugged Polycarbonate construction
- Lens with UV inhibitors
- 360 degree illumination provides outstanding visibility from all angles
- SAE Class 1 certified



FLASH PATTERNS

1. Rapid Front/Back*
2. Single Flash
3. Front/Back
4. Quad
5. Rotating
6. Rotating + Compass + Triple
7. Alternating
8. Double Flash
9. Quint
10. Rapid Alternating

OPTIONS

LENS	LED	MOUNT	CONNECTOR
CLEAR	AMBER	MAGNET	CIGARETTE LIGHTER
CLEAR	AMBER	STUD	CABLE
CLEAR	WHITE	MAGNET	CIGARETTE LIGHTER
CLEAR	WHITE	STUD	CABLE
CLEAR	GREEN	MAGNET	CIGARETTE LIGHTER
CLEAR	GREEN	STUD	CABLE

SPECIFICATIONS

INPUT VOLTAGE RANGE
10-30 VDC

CURRENT DRAW
2.1/3.5A (min/max)

LED COUNT
56

FLASH PATTERNS
10

OPERATING TEMPERATURE
-40 C to +65 C

DIMENSIONS
Length – 15.26"
Width – 8.65"

MOUNTING
Magnet
Stud

CERTIFICATIONS
SAE J845/2139 CLASS 1
FMVSS/CMVSS 108

WARRANTY
3 YEAR

* SAE J845 Class 1 Compliant

PHOENIX CLASS 1 LIGHT BAR INSTALLATION AND MODEL SELECTION

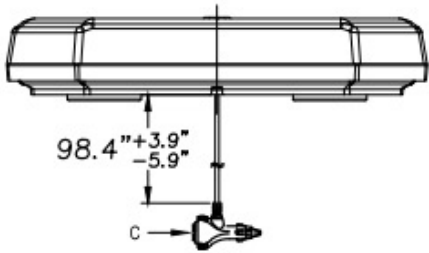

PART NUMBER	SIZE	MOUNT	LENS / LED	CONNECTOR
100LB0031	15"	MAGNET	CLEAR / AMBER	CIGARETTE LIGHTER
100LB0032	15"	STUD	CLEAR / AMBER	CABLE
100LB0033	15"	MAGNET	CLEAR / WHITE	CIGARETTE LIGHTER
100LB0034	15"	STUD	CLEAR / WHITE	CABLE
100LB0035	15"	MAGNET	CLEAR / GREEN	CIGARETTE LIGHTER
100LB0036	15"	STUD	CLEAR / GREEN	CABLE

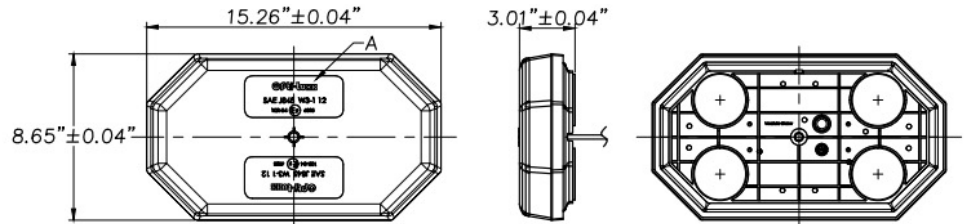
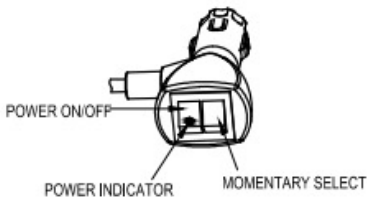

LEARN MORE

To learn more about the Phoenix Class 1 LED Light Bar, please visit our website at www.opti-luxx.com or call (616) 379-4142. Also, see our lighting products in action by following our YouTube channel.



Follow us on YouTube to see more Opti-Luxx products in action, including available flash patterns!



www.opti-luxx.com
(616) 379-4142