

LB5000 Series

Class 1 LED Light Bar



Formerly "Homestead" Series

The LB5000 Series Class 1 LED Light Bar is a compact-designed, low-profile light bar that produces a powerful amber warning signal. The LB5000 is available in 21", 28", 34", 40" and 47" lengths, providing the installation flexibility you need. Streamlined and sleek, the LB5000 is perfect for multiple applications including tow trucks, construction, municipal, service vehicles, and work trucks. All of the LB5000 models are equipped with 10 attention-getting amber flash patterns that will get you noticed and keep you safe. The bracket mounting hardware is included for an easy-to-install, permanent mount to your vehicle. If you're looking for a light bar that dramatically enhances your roadway visibility and looks great while doing it, the LB5000 is the perfect solution.

FEATURES



- 5 light bars in the series
- Low profile, linear design
- Rugged Polycarbonate construction
- Lens with UV inhibitors
- 360 degree illumination provides outstanding visibility from all angles
- SAE Class 1 certified



FLASH PATTERNS

1. Single Flash*
2. Directional + Alternating + Flash
3. Single + Quint
4. Single + Triple + Quint
5. Alternating + Rapid Alternating + Flash
6. Alternating + Double Flash
7. Triple
8. Alternating + Triple Flash
9. Alternating
10. Directional

CONFIGURATION

LENS	LED	MOUNT	CONNECTION
 CLEAR	 AMBER	BRACKET	3-WIRE CABLE

* SAE J845 Class 1 Compliant

SPECIFICATIONS

INPUT VOLTAGE RANGE

9-16 VDC

CURRENT DRAW

2.5/6.5A (min/max)

LED COUNT

Varies depending on size

FLASH PATTERNS

10

OPERATING TEMPERATURE

-40° C to +65° C

DIMENSIONS

Length – varies

Width – 8.90" at widest point

MOUNTING

Permanent (Screw)

CERTIFICATIONS

FMVSS/CMVSS 108

SAE STANDARDS J845/2139

CLASS 1

WARRANTY

3 YEAR

LB5000 SERIES LED LIGHT BAR DIMENSIONS AND MODEL SELECTION

PART NUMBER	SIZE "A"	MOUNT	LENS / LED	CONNECTION
100LB0008	21"	BRACKET	CLEAR / AMBER	3-WIRE CABLE
100LB0009	28"	BRACKET	CLEAR / AMBER	3-WIRE CABLE
100LB0010	34"	BRACKET	CLEAR / AMBER	3-WIRE CABLE
100LB0011	40"	BRACKET	CLEAR / AMBER	3-WIRE CABLE
100LB0012	47"	BRACKET	CLEAR / AMBER	3-WIRE CABLE

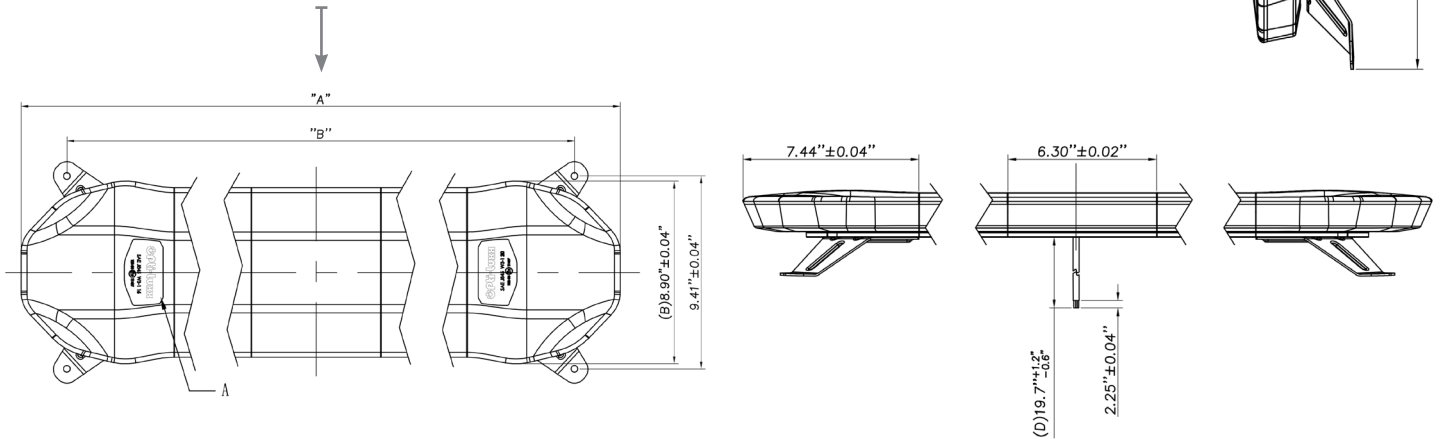
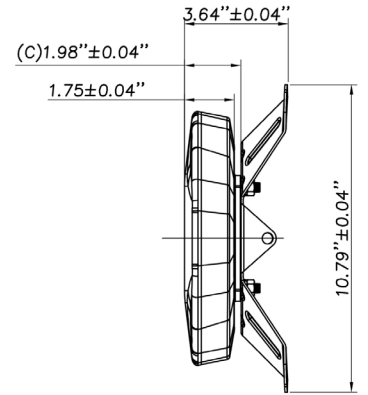

LEARN MORE

To learn more about the LB5000 Series Class 1 LED Light Bar, please visit our website at www.opti-luxx.com or call (616) 379-4142. Also, see our lighting products in action by following our YouTube channel.



Follow us on YouTube to see more Opti-Luxx products in action, including available flash patterns!



www.opti-luxx.com
(616) 379-4142