

LB1500 Series*

Class 1 LED Light Bar

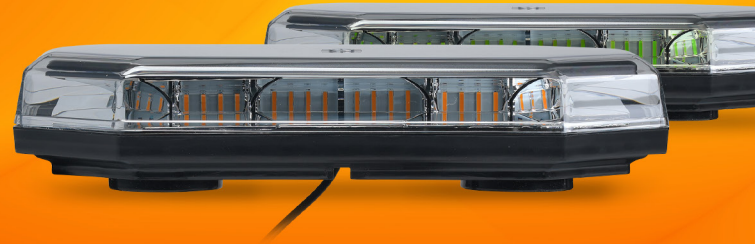

*Formerly "Phoenix" Series

The LB1500 Series Class 1 LED Light Bar is a sturdy, compact-designed high-profile light bar that produces a powerful amber, white, or green warning signal. Measuring 15" wide, this versatile light bar packs a punch despite its small footprint. Multiple mounting options available, including a magnetic mount which includes a cigarette lighter adapter that allows you to toggle through all 10 flash patterns quickly and easily, providing you with great flexibility on the job. A perfect solution for multiple applications, including construction, municipal, service vehicles, and work trucks. Multiple options available for both LED and lens color, including a green LED signal.

FEATURES

- 6 light bars in the series
- Rugged Polycarbonate construction
- Lens with UV inhibitors
- 360 degree illumination provides outstanding visibility from all angles
- SAE Class 1 certified



FLASH PATTERNS

1. Rapid Front/Back*
2. Single Flash
3. Front/Back
4. Quad
5. Rotating
6. Rotating + Compass + Triple
7. Alternating
8. Double Flash
9. Quint
10. Rapid Alternating

OPTIONS

LENS	LED	MOUNT	CONNECTOR
<input type="radio"/> CLEAR	<input checked="" type="radio"/> AMBER	MAGNET	CIGARETTE LIGHTER
<input type="radio"/> CLEAR	<input checked="" type="radio"/> AMBER	STUD	CABLE
<input type="radio"/> CLEAR	<input type="radio"/> WHITE	MAGNET	CIGARETTE LIGHTER
<input type="radio"/> CLEAR	<input type="radio"/> WHITE	STUD	CABLE
<input type="radio"/> CLEAR	<input checked="" type="radio"/> GREEN	MAGNET	CIGARETTE LIGHTER
<input type="radio"/> CLEAR	<input checked="" type="radio"/> GREEN	STUD	CABLE

SPECIFICATIONS

INPUT VOLTAGE RANGE
10-30 VDC

CURRENT DRAW
2.1/3.5A (min/max)

LED COUNT
56

FLASH PATTERNS
10

OPERATING TEMPERATURE
-40 C to +65 C

DIMENSIONS
Length – 15.26"
Width – 8.65"

MOUNTING
Magnet
Stud

CERTIFICATIONS
SAE J845/2139 CLASS 1
FMVSS/CMVSS 108

WARRANTY
3 YEAR

* SAE J845 Class 1 Compliant

LB1500 SERIES CLASS 1 LIGHT BAR INSTALLATION AND MODEL SELECTION

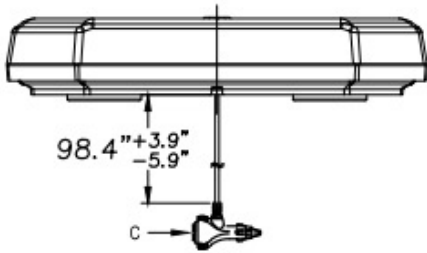

PART NUMBER	SIZE	MOUNT	LENS / LED	CONNECTOR
100LB0031	15"	MAGNET	CLEAR / AMBER	CIGARETTE LIGHTER
100LB0032	15"	STUD	CLEAR / AMBER	CABLE
100LB0033	15"	MAGNET	CLEAR / WHITE	CIGARETTE LIGHTER
100LB0034	15"	STUD	CLEAR / WHITE	CABLE
100LB0035	15"	MAGNET	CLEAR / GREEN	CIGARETTE LIGHTER
100LB0036	15"	STUD	CLEAR / GREEN	CABLE

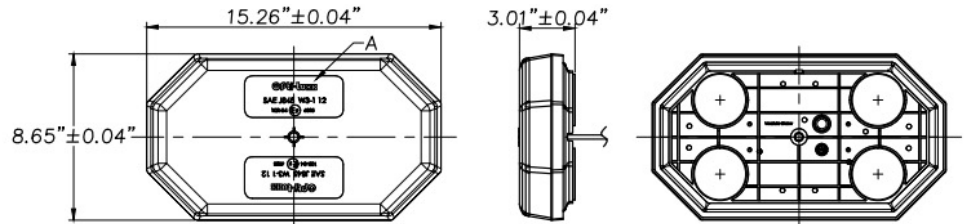
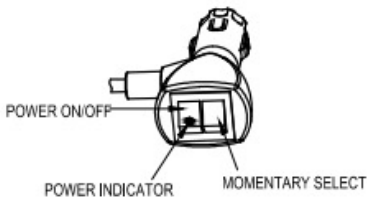

LEARN MORE

To learn more about the LB1500 Series Class 1 LED Light Bar, please visit our website at www.opti-luxx.com or call (616) 379-4142. Also, see our lighting products in action by following our YouTube channel.



Follow us on YouTube to see more Opti-Luxx products in action, including available flash patterns!



www.opti-luxx.com
(616) 379-4142