

MICHIGAN

600 Series 6" Oval LED Warning Light



The Michigan LED Warning Light produces an attention-grabbing warning signal that is designed to meet the demands of multiple commercial vehicles including work trucks, municipal, construction, tow, and delivery. Available in both a 4" round and a 6" oval option, the Michigan LED Warning Light produces a powerful amber or green warning signal. It features 8 different flash patterns to choose from and is easily connected to your vehicle with the included three pin amp connector. Get noticed and stay safe with the Michigan LED Warning Light.

FEATURES

- 4" round and 6" oval available in the series
- Amber or green LED options
- High output LED's with 8 flash patterns
- Available with grommet mount and connector
- SAE CLASS 1 Certified



FLASH PATTERNS

1. Quint
2. Rapid Single
3. Double
4. Quad
5. Single Flash
6. Single Slow
7. Single Pace
8. Rapid Double

OPTIONS

| LENS | LED | MOUNT | CONNECTOR |
|-------|-------|---------|---|
| CLEAR | AMBER | Grommet | Wire w/3 pin amp connector or order without connector |
| CLEAR | GREEN | Grommet | Wire w/3 pin amp connector |

SPECIFICATIONS

INPUT VOLTAGE RANGE
9-16VDC

CURRENT DRAW
255/411mA (min/max)

LED COUNT
20

FLASH PATTERNS
8

OPERATING TEMPERATURE
-40° C to +65° C

DIMENSIONS
Height – 1.06"
Length – 7.44"

MOUNTING
Grommet

CERTIFICATIONS
SAE Standard: J595, Class 1
IP Code IP67

WARRANTY
3 YEAR

MICHIGAN 600 SERIES 6" OVAL LED WARNING LIGHT

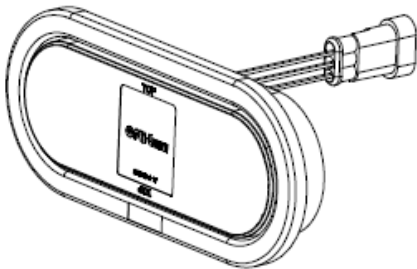
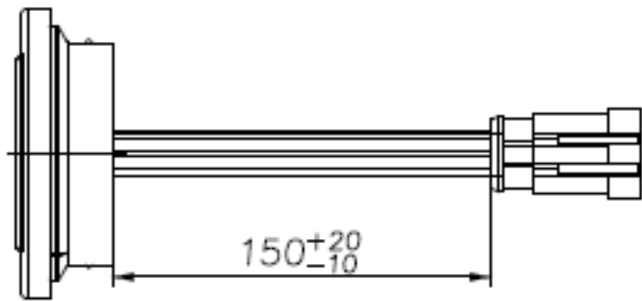
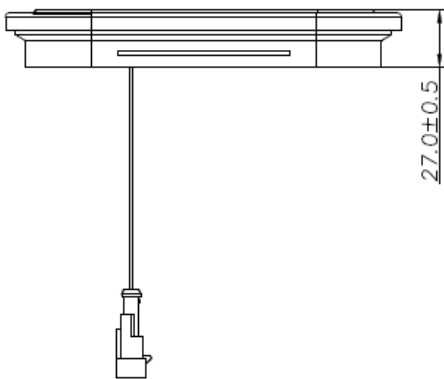
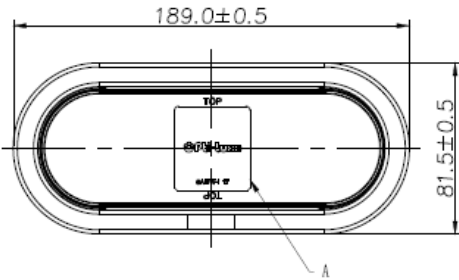

| PART NUMBER | MOUNT | LENS / LED | CONNECTOR |
|-------------|---------|-------------------|---|
| 100WA0001 | GROMMET | ○ CLEAR / ● AMBER | Wire w/3 pin amp connector |
| 100WA0005 | GROMMET | ○ CLEAR / ● GREEN | — |
| 110WA0010 | GROMMET | ○ CLEAR / ● GREEN | Wire w/3 pin amp connector w/jumper harness kit |
| 110WA0014 | GROMMET | ○ CLEAR / ● AMBER | — |

LEARN MORE

To learn more about the Michigan Series LED Beacon, please visit our website at www.opti-luxx.com or call (616) 379-4142. Also, see our lighting products in action by following our YouTube channel.



Follow us on YouTube to see more Opti-Luxx products in action, including available flash patterns!



www.opti-luxx.com
(616) 379-4142