

# MICHIGAN

## Class 1 LED Warning Light — 6" Oval



The Michigan Class 1 LED Warning Light produces an attention-grabbing warning signal that is designed to meet the demands of multiple commercial vehicles including work trucks, municipal, construction, tow, and delivery. Available in both a 4" round and a 6" oval option, the Michigan series produces a powerful amber warning signal. Comes standard with 8 different flash patterns to choose from and is easily connected to your vehicle with the included three pin amp connector. Get noticed and stay safe with the Michigan Series of warning lights.

### FEATURES



- 4" round and 6" oval available in the series
- High output LED's with 8 flash patterns
- Includes grommet mount and connector
- SAE Class 1 certified



### FLASH PATTERNS

1. Quint
2. Rapid Single
3. Double
4. Quad
5. Single
6. Single Slow
7. Single Flash
8. Rapid Double

### OPTIONS

| LENS  | LED   | MOUNT   | CONNECTOR                  |
|---|---|---------|----------------------------|
|  CLEAR |  AMBER | Grommet | Wire w/3 pin amp connector |

### SPECIFICATIONS

**INPUT VOLTAGE RANGE**  
9-16VDC

**CURRENT DRAW**  
255/411mA (min/max)

**LED COUNT**  
20

**FLASH PATTERNS**  
8

**OPERATING TEMPERATURE**  
-40° C to +65° C

**DIMENSIONS**  
Height – 1.06"  
Length – 7.44"

**MOUNTING**  
Grommet

**CERTIFICATIONS**  
SAE Standard: J595, Class 1  
IP Code IP67

**WARRANTY**  
3 YEAR

**MICHIGAN CLASS 1 LED WARNING LIGHT – 6" OVAL**

Measurements shown in millimeters.

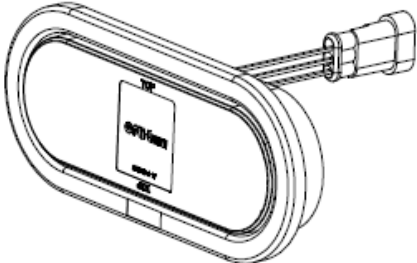
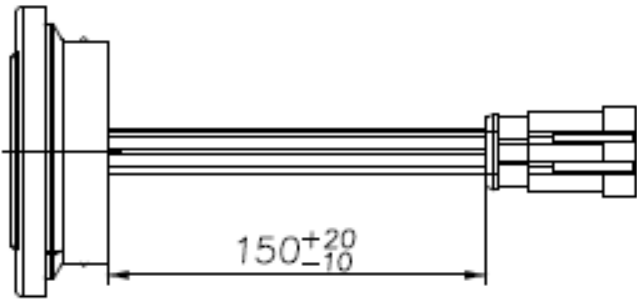
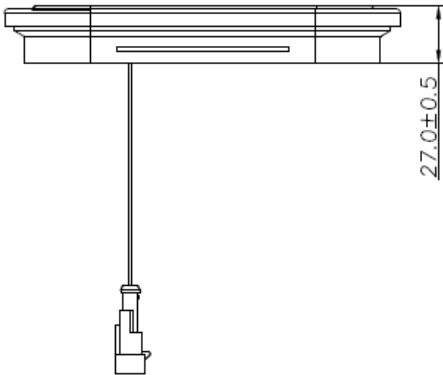
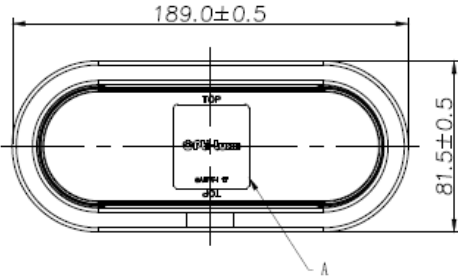

ISO VIEW

| PART NUMBER | MOUNT   | LENS / LED        | CONNECTOR                  |
|-------------|---------|-------------------|----------------------------|
| 100WA0001-A | GROMMET | ○ CLEAR / ● AMBER | Wire w/3 pin amp connector |

**LEARN MORE**

To learn more about the Michigan Series LED Warning Light, please visit our website at [www.opti-luxx.com](http://www.opti-luxx.com) or call (616) 379-4142. Also, see our amber lighting products in action by following our YouTube channel.



*Follow us on YouTube to see more Opti-Luxx products in action, including available flash patterns!*



[www.opti-luxx.com](http://www.opti-luxx.com)  
(616) 379-4142